

packed properly, to avoid any damage during transportation. Factory not responsible for the damages caused by the user themself unproper disassemble.

Specifications

dimmmable	5-grade brightness
Max luminous(30cm)	>1500LUX (30CM)
luminous flux	> 400LM
Working voltage	12V-1000mA
Color temperature	Cold light 5500K ± 500K
	Warm light 3000K ± 280K
	Natural light 4200K ± 400K
Maximum wattage	12W

Warranty Card

Applicable for:

- Since buying date, the user enjoys one year free repair services under normal use. After one year, will be charged according to each component part cost.
- In case change component part, will be charged according to our company's component part cost list.
- The following situations not free repair in Warranty period.
 - 1) Damage caused by natural earthquake, rat disaster, and unnormal use.
 - 2) Damage caused in transportation, fall, and unproper storage.
 - 3) Consumable component, such as spare parts, batteries, light bulbs, etc.
 - 4) Warranty information record is not complete, no purchase date, no buying shop seal, etc.
 - 5) Featured using environment, such as humidity, sulfur area, high salty and the ship, etc, easy corrosion area.
 - 6) Using not according to the instructions.
 - 7) Special offer.
- When return to factory for repair, the user should make sure the LED lamp packed properly, to avoid any damage during transportation.
- Factory not responsible for the damages caused by the user themself unproper disassemble.

lamp holder breaks * The lamp holder smokes or sparks * The abnormal flickering or break of the LED light bulb

Important!

Thank you for purchasing our products.

To guarantee your rights, please fill in this form properly, thank you!

Name	
Address	
Telephone	
Invoice number	
Purchase date	
Item number	
dealers	
Note: this field requires the dealers seal!	
Warning: please keep this warranty paper for repair presentation.	
Attention:	

- Do not Self-disassemble the product, to avoid any electric shock.
- Please use vender's specified adapter and power socket, to maintain normal working.
- Please do not over-adjusting the joint activity parts, to avoid any damage to the lamp.
- Please do not use the lamp in high-temperature or high-humidity environment.
- Please don't look at the LED lightsouce straightly, to avoid your eyes hurt.
- In case below conditions occur, please pull out the power cord, stop using (if needed, please call for help):
 - The power cord or power plug break
 - The lamp holder damp or rain
 - The shell and joint activities of the lamp holder breaks
 - The lamp holder smokes or sparks
 - The abnormal flickering or break of the LED light bulb

THORGEON
LED TABLE LAMP
09003

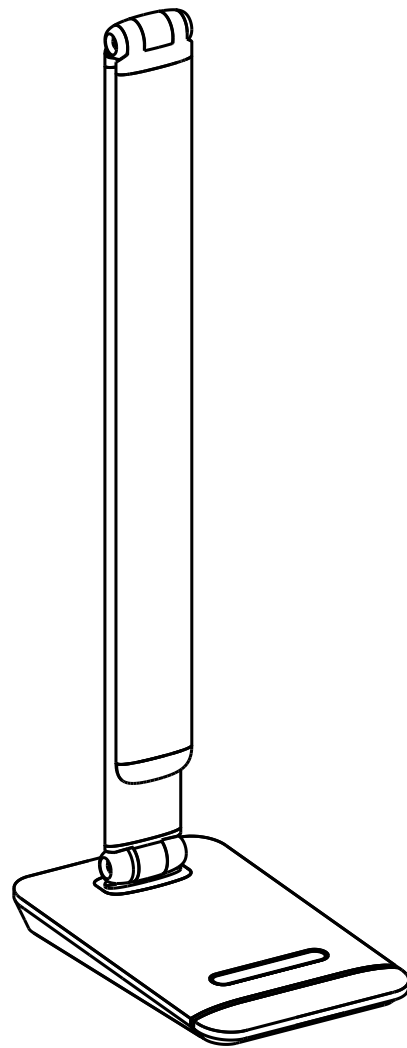

Instruction

Battery replacement

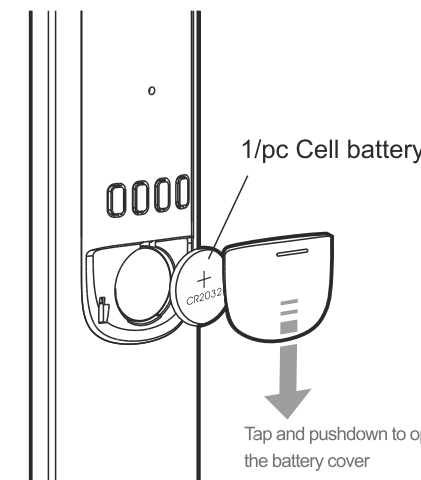

LCD screen brightness

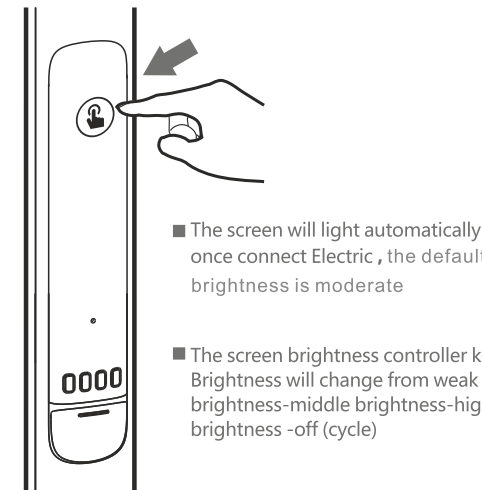

User guider

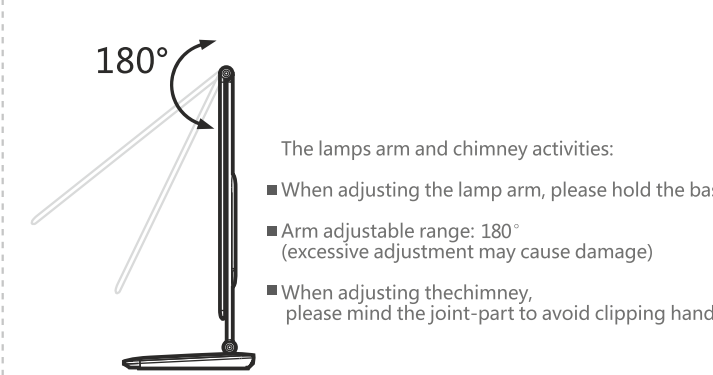
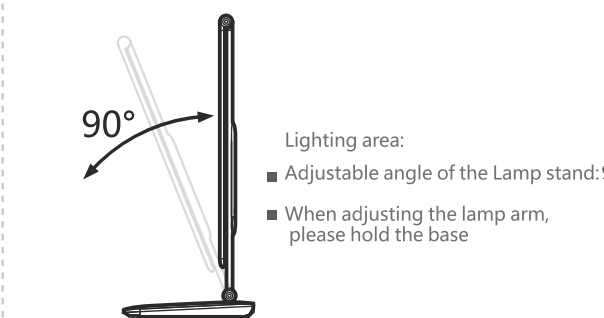
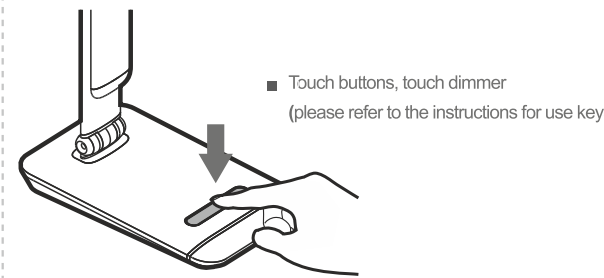
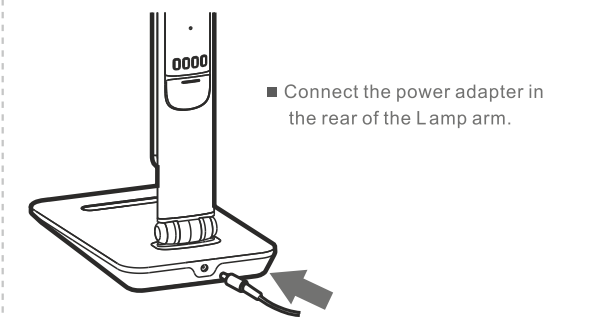

Operation instructions

- Touch key: Light adjustable instruction (as picture below)

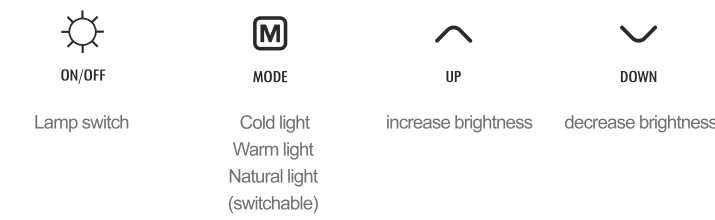

- Nightlight button operation (as picture below)

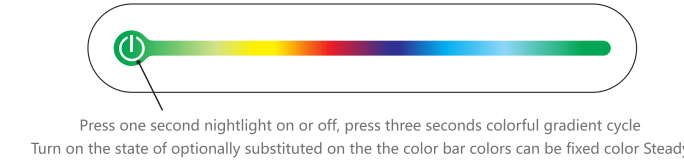

- Calendar operation instruction:(as below picture)



- Date and Time setting
 - 1.In normal mode,press "set" key to achieve setting functions, press against to move next, sequence : Hour-Minute-Year-Month-Day.
 2. Press "up" and "down" to setting.
 3. In setting mode,press mode or stop operation in one munite to exit setting, and display time.
 4. In normal mode, press "down" key to switch between"12H"or"24H" display.
- Snooze function setting
 1. In normal mode, press "mode" key to active alarm setting.
 - 2.In alarm mode,press "set" key to set the alarm time, sequence: Hour-Munite-Snooze-Music-Exit.
 - 3.Press "up"and"down"to setting
 - 4.In alarm mode,press "up"and "down" to turn on/off alarm and snooze function, press again to achieve next function, sequence: alarm on- snooze on-alarm off-snooze off
 - 5.When come to alarm time,will ring 1 munite, then snooze and ring again. Press any key to off alarm.
- Temperature switch
 - In normal mode,press "down" key to switch between "F"and "C" display.

Battery replacement

ness-high brightness -off (cycle)
User guider

Connect the power adapter in the rear of the

Operation instructions
Operation instructions

Touch key: Light adjustable instruction (as picture

packed properly, to avoid any damage during transportation. Factory not responsible for the damages caused by the user themself unproper disassemble.

Specifications

dimmmable	5-grade brightness
Max luminous(30cm)	>1500LUX (30CM)
luminous flux	>400LM
Working voltage	12V-1000mA
Color temperature	Cold light 5500K ± 500K
	Warm light 3000K ± 280K
	Natural light 4200K ± 400K
Maximum wattage	12W

Warranty Card

Applicable for:

- Since buying date, the user enjoys one year free repair services under normal use. After one year, will be charged according to each component part cost.
- In case change component part, will be charged according to our company's component part cost list.
- The following situations not free repair in Warranty period.
 - 1) Damage caused by natural earthquake, rat disaster, and unnormal use.
 - 2) Damage caused in transportation, fall, and unproper storage.
 - 3) Consumable component, such as spare parts, batteries, light bulbs, etc.
 - 4) Warranty information record is not complete, no purchase date, no buying shop seal, etc.
 - 5) Featured using environment, such as humidity, sulfur area, high salty and the ship, etc, easy corrosion area.
 - 6) Using not according to the instructions.
 - 7) Special offer.
- When return to factory for repair, the user should make sure the LED lamp packed properly, to avoid any damage during transportation.
- Factory not responsible for the damages caused by the user themself unproper disassemble.

lamp holder breaks * The lamp holder smokes or sparks * The abnormal flickering or break of the LED light bulb

Important!

Thank you for purchasing our products.

To guarantee your rights, please fill in this form properly, thank you!

Name

Address

Telephone

Invoice number

Purchase date

Item number

dealers

Note: this field requires the dealers seal!

Warning

please keep this warranty paper for repair presentation.

Attention:

■ Do not Self-disassemble the product, to avoid any electric shock.

■ Please use vender's specified adapter and power socket, to maintain normal working.

■ Please do not over-adjusting the joint activity parts, to avoid any damage to the lamp.

■ Please do not use the lamp in high-temperature or high-humidity environment.

■ Please don't look at the LED lightsource straightly, to avoid your eyes hurt.

■ In case below conditions occur, please pull out the power cord, stop using (if needed, please call for help):

- The power cord or power plug break
- The lamp holder damp or rain
- The shell and joint activities of the lamp holder breaks
- The lamp holder smokes or sparks
- The abnormal flickering or break of the LED light bulb

THORGEON
LED TABLE LAMP
09003

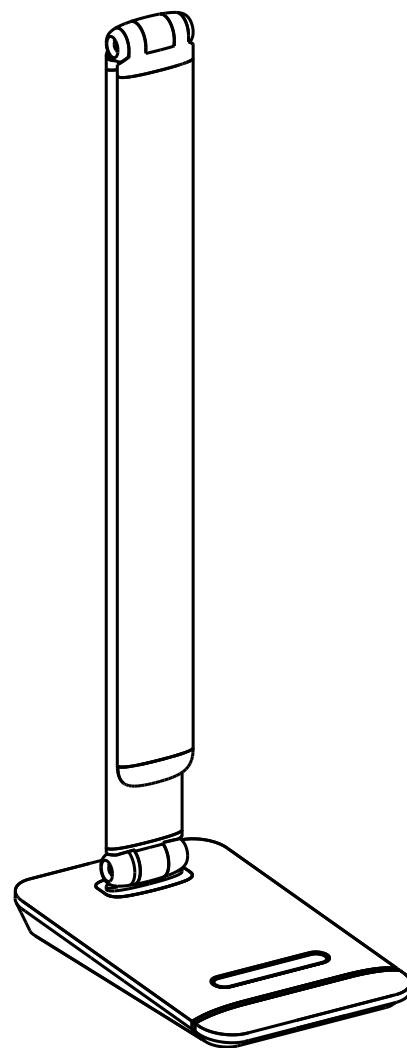

Instruction

Battery replacement

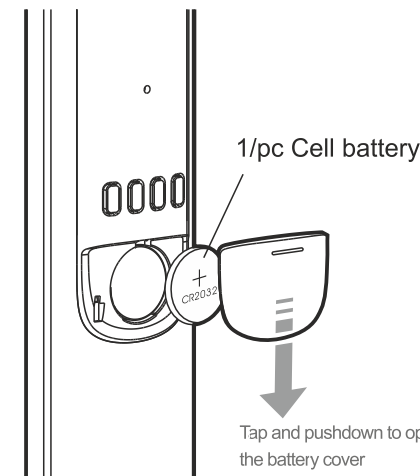

LCD screen brightness

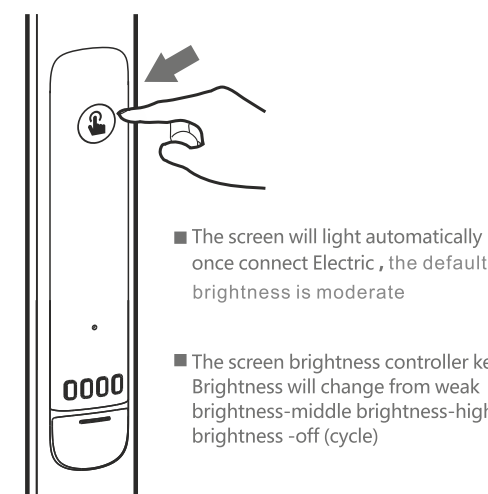

User guider

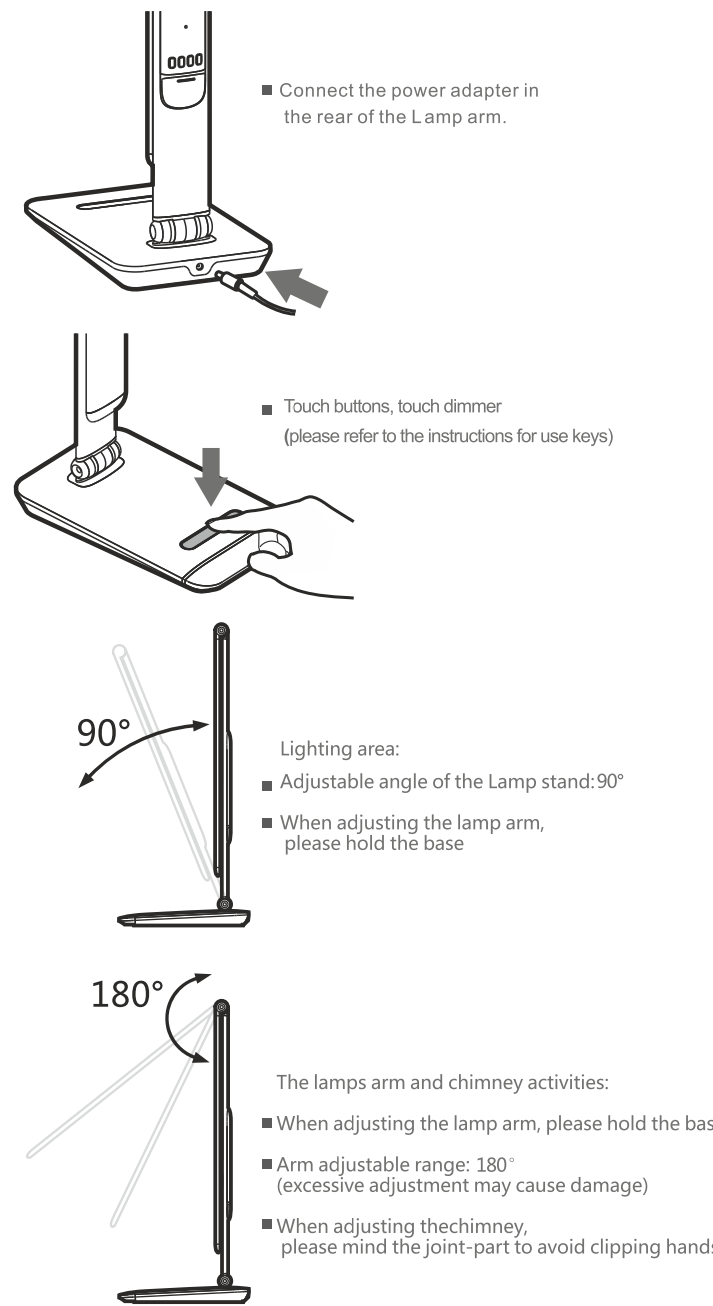

Operation instructions

- Touch key: Light adjustable instruction (as picture below)

ON/OFF

MODE

UP

DOWN

Lamp switch

Cold light
Warm light
Natural light
(switchable)

increase brightness

decrease brightness
- Nightlight button operation (as picture below)

ON/OFF

MODE

UP

DOWN

Lamp switch

Cold light
Warm light
Natural light
(switchable)

increase brightness

decrease brightness

Press one second nightlight on or off, press three seconds colorful gradient cycle
Turn on the state of optionally substituted on the the color bar colors can be fixed color Steady
- Calendar operation instruction:(as below picture)

UP

DOWN

S

M

SET

MODE
- Date and Time setting
 - 1.In normal mode,press "set" key to achieve setting functions, press against to move next, sequence :

Hour-Minute-Year-Month-Day.
 2. Press "up" and "down" to setting.
 3. In setting mode,press mode or stop operation in one munite to exit setting, and display time.
 4. In normal mode,press "down" key to switch between"12H"or"24H" display.
- Snooze function setting
 1. In normal mode, press "mode" key to active alarm setting.
 - 2.In alarm mode,press "set" key to set the alarm time, sequence:

Hour-Munite-Snooze-Music-Exit.
 - 3.Press "up"and"down"to setting
 - 4.In alarm mode,press "up" and "down" to turn on/off alarm and snooze function,press again to achieve next function, sequence: alarm on- snooze on-alarm off-snooze off
 - 5.When come to alarm time, will ring 1 munite, then snooze and ring again. Press any key to off alarm.
- Temperature switch
In normal mode,press "down" key to switch between "F" and "C" display.

Battery replacement

ness-high brightness -off (cycle)
User guider

Connect the power adapter in the rear of the

Operation instructions
Operation instructions

Touch key: Light adjustable instruction (as picture